

SIX EASY STEPS TO ORDER AN INSTALLATION TOOL

1

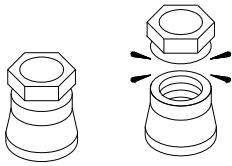

STALL TYPE NUT

TO INSTALL HI-LOK TYPE BREAK AWAY FASTENERS

A **STALL TYPE INSTALLATION TOOL** is used for this style threaded fastener. The torque value is built into the collar. When it reaches the pre determined torque value the driving hex breaks away leaving the collar (or nut) installed. Care must be taken not to install fasteners with a torque value beyond the design of the attachment.

2

HOW ARE THE BOLTS OR PINS FIT INTO THE STRUCTURE ?

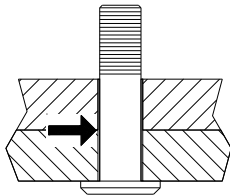

LOOSE OR
NON INTERFERENCE FIT

The holes are prepared slightly larger than the shank of the pins. The pins are loose in the holes and need something to hold them from rotating while the fasteners are installed.

The pins have a female hex on the threaded end. We have a hex key system that places a hex key (like a allen wrench) through the socket and into the hex of the pin. This hex key is attached to the tool with a key control assembly and is used to keep the pin from rotating while the collar or nut is installed.

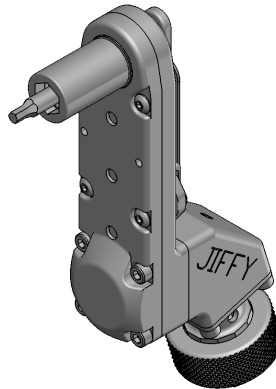

key control assembly with
socket and key

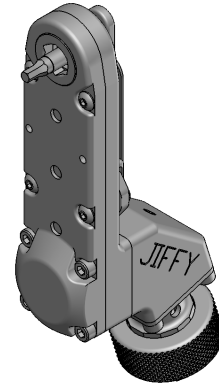

Key control assembly with
flush gear and key

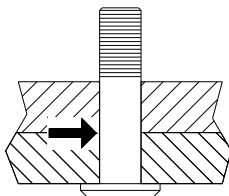

INTERFERENCE FIT

The holes are prepared slightly smaller than the shank of the pins. The pins are forced into the holes and are held in place by this tight fit. The pins will not rotate when nuts are tightened on them.

No key control assembly is needed.

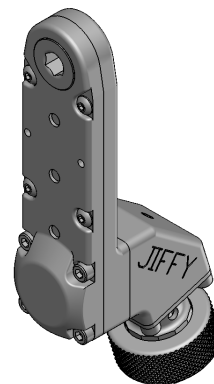

Attachment with hex thru gear
and no key control assembly

While the key control assemblies shown are for 17 degree attachments
The principal is the same for all installation attachments.

3 TOOL CONFIGURATION

Pick a style of tool that will allow access to the fasteners.
The tool groups correspond to catalog sections.

STALL TYPE INSTALLATION TOOLS

For Hi-Lok Hi-Lite Hi-Tigue Fasteners

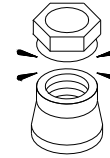

17 Degree
Fixed
Angle Heads



Available in
Series 1
Series 2
Series 3

17 Degree
Indexable
Angle Heads



Available in
Series 1
Series 2
Series 3

20 Degree
Fixed
Angle Heads



Available in
Series 4

20 Degree
Indexable
Angle Heads

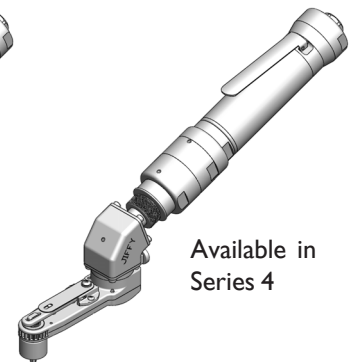

Available in
Series 4

20 DEGREE
RATCHET
WRENCH

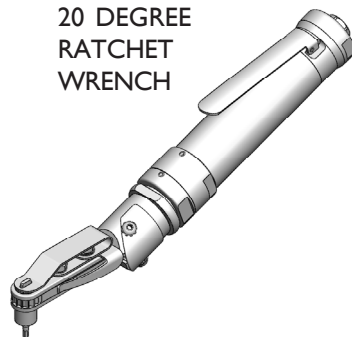

STRAIGHT
RATCHET
WRENCH

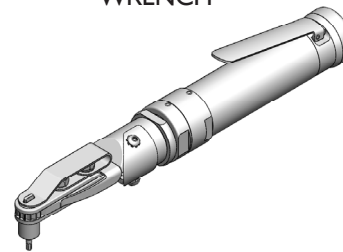

L TYPE INSTALLATION

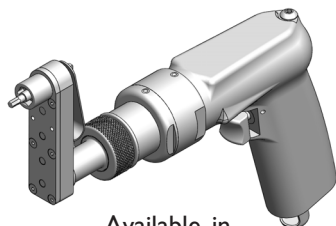

Available in
Series 1
Series 2
Series 3

STRAIGHT INSTALLATION

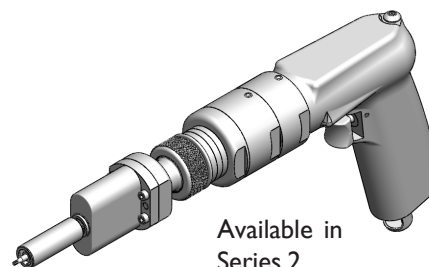

Available in
Series 2
Series 3

4 WHAT TORQUE VALUE IS REQUIRED BY THE FASTENER

Stall type installation tools need to supply and withstand about twenty percent more torque than is required to install or break away the fastener.
 If you don't know what torque the fastener installs at we will test the fastener at Jiffy Air Tool and supply a recommendation .

5 MATCH THE TOOL TO THE FASTENER

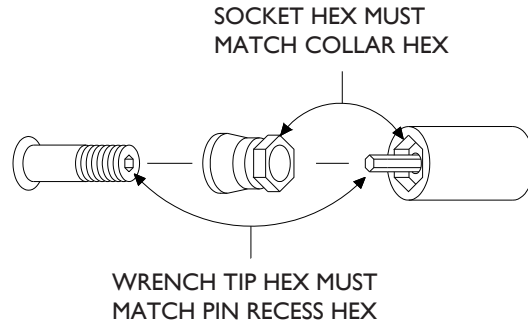

Typical Socket Sizes available for Series																	
SOCKET HEX	7/32	1/4	9/32	5/16	5/16	11/32	3/8	7/16	1/2	9/16	5/8	11/16	3/4	13/16	7/8	15/16	
SERIES 1	Attachments Rated At 60 Inch Lbs / 6.77 Nm maximum																
SERIES 2	Attachments Rated At 120 Inch Lbs / 13.55 Nm Maximum																
SERIES 3				Attachments Rated At 350 Inch Lbs / 39.54 Nm Maximum													
SERIES 4						Attachments Rated At 525 Inch Lbs / 59.31 Nm Maximum											

Typical Key Sizes available for Series								
KEY SIZE	1/16	5/64	3/32	1/8	5/32	3/16	7/32	1/4
SERIES 1								
SERIES 2								
SERIES 3								
SERIES 4								

Socket tables are arranged by series
 Each series is organized by key size matched to sockets.
 Series 2 and 3 are combined into series 2 / 3

6 ASSEMBLE COMPLETE TOOL ORDER NUMBER

- 1) TOOL ORDER NUMBER
 Add "U" if no hex key is needed.
- 2) OPTION CODE (If needed).
 Options are listed at the front of tool sections.
- 3) NOSE GEAR NUMBER
 Types and options are listed on tool pages.
- 4) SOCKET OR SOCKET ACCESSORY NUMBER (If needed).